

*Welcome Home*

The Capital Campaign for  Wellspring Living

# About WELLSPRING LIVING

Since 2001, Wellspring Living has provided domestic sex trafficking survivors and those at risk (ages 12+) with comprehensive, trauma-informed, participant-centered care through residential programs, community-based programs, and graduate services—all at no cost to participants. Each program utilizes a multi-disciplinary service model to provide transformative care through five service pillars: therapy, education, life skills, career readiness, and case management.



## Our Mission:

**TRANSFORMING LIVES OF THOSE AT RISK OR VICTIMIZED BY SEXUAL EXPLOITATION**

## Our Vision:

**A WORLD WHERE EVERY SURVIVOR OF SEXUAL EXPLOITATION HAS ACCESS TO TRANSFORMATIVE CARE**

**Wellspring Living's service model and demonstrated results have earned local, regional, and national recognition through accolades including but not limited to:**

- The second program in the nation to be awarded a Gold Certification from the national Safe House Certification Review Board, led by Safe House Project, in June 2022
- Recognition at the first White House Human Trafficking Summit in January 2020
- Appointment to the GRACE Commission in 2019 by Georgia's First Lady, Marty Kemp
- Recipient of the Martin Luther King Community Service Award, the AKA Humanitarian Award, the Power of One Award from International Rotary, and the City of Atlanta Phoenix Award
- Staff appointment to the U.S. Advisory Council on Human Trafficking

## ALEXIS' STORY

*Alexis did not get the chance to be a kid, to experience the "normal" things that many of us may take for granted growing up. Her childhood was marked by abuse, neglect, and feelings of hopelessness. After facing years of exploitation as a child and young adult, she was ready for a fresh start at Wellspring Living—even though she knew this would not be easy, particularly with a young daughter to care for.*

*While in the **Women's Residential Program**, Alexis also took part in the **Women's Academy**, where she learned career readiness skills, gained confidence, and worked toward obtaining living wage employment to break the generational curses she felt she was bound by earlier in life. She recently moved into her own home at the **Graduate Village**, where she has been reunited with her daughter and remains focused on her journey toward freedom and self-sufficiency.*

## FRIENDS AND SUPPORTERS,

For more than two decades, **Wellspring Living** has been serving sex trafficking survivors like Alexis and providing safety, freedom, restoration, and hope to thousands of youth, women, and their children across Georgia and beyond. Through Wellspring Living's wraparound services, I have seen firsthand the transformation that is possible when the needs of survivors are placed at the center of their healing journey.

As we look ahead toward future decades of impact, we are laying the foundation for new stories of transformation by building a community that reflects this philosophy, with the youth and women we have served—and will serve in the future—at the heart of its design. Our Welcome Home Campaign, the first comprehensive campaign in our history, will enable Wellspring Living to:

1. **Deepen our impact** by creating a true continuum of care on our seven-acre South Campus, one of the first of its kind in the United States where survivors or those at risk can walk through our doors and breathe a sigh of relief knowing they have the safe space, support, and resources they need to find hope and healing; and
2. **Broaden and sustain our impact** by expanding our program capacity, enhancing operational efficiencies, strengthening our operating reserves, and creating a dedicated home for our Wellspring Living Institute, where peer organizations can experience hands-on training and support to better serve survivors and those at risk in their own communities.

Each survivor carries within them a source—a wellspring—of strength and resilience. Together, we can open our doors and say "Welcome Home" to more youth, women, and their children on a path to find the courage to move forward, the confidence to succeed, and the ability to live and dream again. Thank you for walking this journey alongside us.

**WITH GRATITUDE,**

**Mary Frances Bowley**  
Founder and Executive Director

# Broadening OUR IMPACT

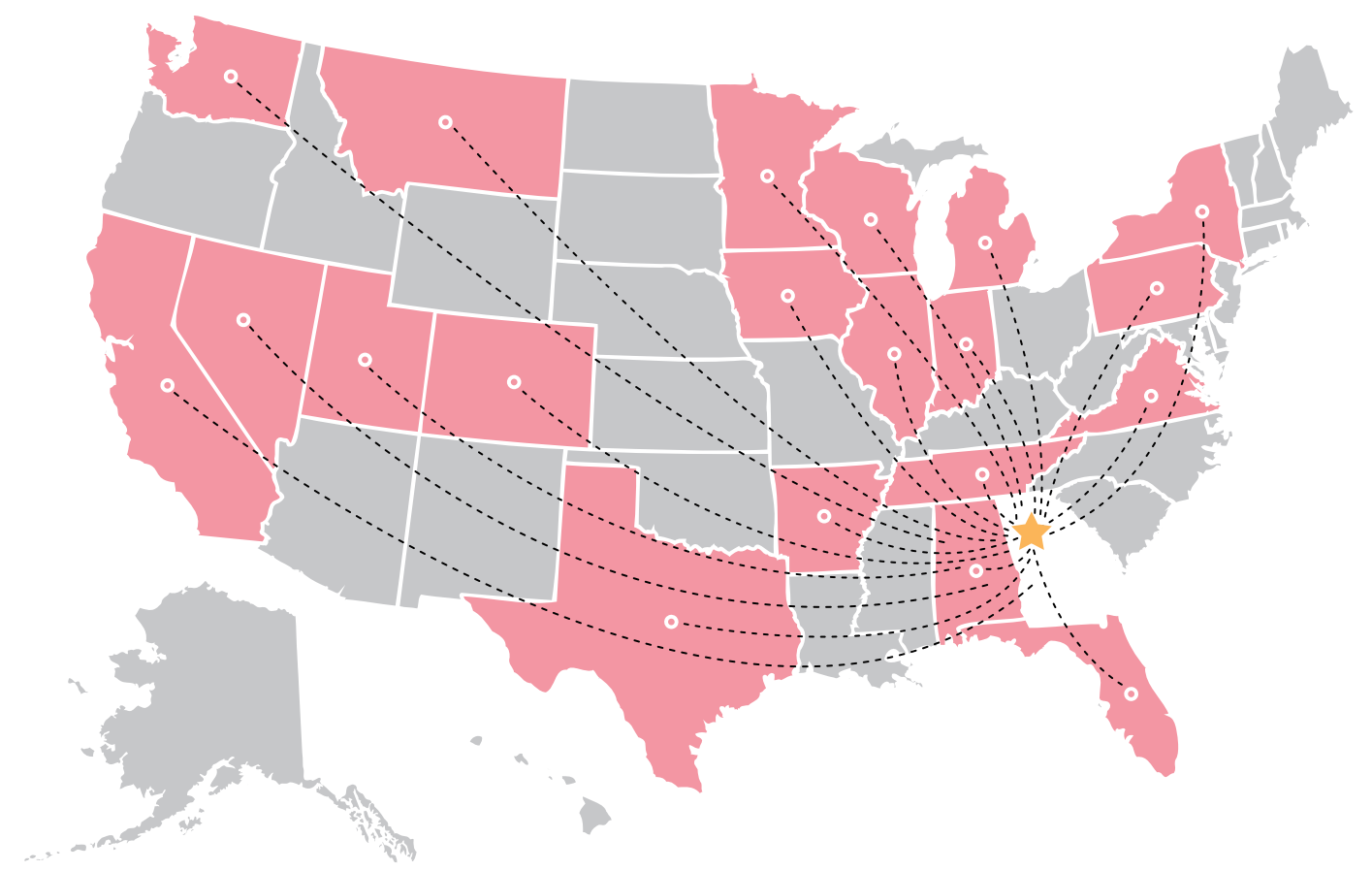

Since its beginnings in 2010, the Wellspring Living Institute has provided training and technical assistance to more than 9,000 participants in 40+ organizations, from start-up nonprofits to well-established organizations.

Wellspring Living believes the most prudent method to scale specialized services for survivors of exploitation all over the world is to train partner organizations near and far in the use of evidence-based, participant-centered, trauma-informed, culturally sensitive approaches. **The Wellspring Living Institute** serves as a learning lab where partners can come to observe, train, and replicate our model in their own communities to better serve survivors.

With more than 5,000 square feet of dedicated space for hosting and training Institute clients, the new Cornerstone Building and Activities & Training Building will power more immersive training experiences and increase the number of clients served by more than 60 percent—from 30 partner organizations each year to 50+ organizations each year—with capacity to serve even more during future stages of growth.

Campaign funds will support the increased operating costs of expanding the Institute along with signature programming and services over a three-year period to serve a greater number of survivors.

"Wellspring Living stands in a class of its own thanks to its wraparound services, exceptional standards of care, and trauma-informed therapeutic interventions specifically designed for trafficking survivors. Mary Frances has been at the forefront of this work in Metro Atlanta for the last two decades and is now a nationally recognized thought leader for organizations looking to confront this issue in their own communities."

Shan Cooper, Founder and CEO, Journey Forward Strategies

Every night in Atlanta and throughout Georgia, *hundreds* of youth and women are sold for sex.

In 2021, Wellspring Living served 370 individuals throughout our service footprint in Metro Atlanta. **The Welcome Home Campaign** will enable Wellspring Living to deepen our impact by creating a centralized continuum of care and double the total number of survivors we can serve.

>50% OF METRO ATLANTA'S HOMELESS YOUTH HAVE EXPERIENCED **EXPLOITATION** IN THEIR LIFETIME

>80% OF SURVIVORS SERVED BY WELLSPRING LIVING ARE FROM **COMMUNITIES OF COLOR**

>65% OF SURVIVORS IN THE UNITED STATES DO NOT **GRADUATE** FROM HIGH SCHOOL

80% OF SURVIVORS WILL BE TRAFFICKED **AGAIN** IF THEY HAVE NO SAFE PLACE TO GO

# Deepening OUR IMPACT

Georgia's continuum of care for trafficking survivors is fragmented across multiple locations and providers in Metro Atlanta, making it difficult for survivors to access the comprehensive care they need. Our vision for the **Welcome Home Campaign** creates a safe space for survivors to call home while they progress through an **enhanced and expanded care continuum**—removing as many barriers as possible to lasting freedom and self-sufficiency. Most importantly, it will help even more victims find their path to healing.

The projects prioritized in this phase of campus growth will enable Wellspring Living to serve 460+ individuals each year on our South Campus as well as enhance operational efficiencies at one centralized location. **Of note, these spaces will increase residential services by nearly 90% and more than triple capacity across all programming facilitated on our South Campus.**

**"Delta's mission of bringing the world closer together** starts by proudly partnering with great organizations like Wellspring Living on their vision of creating a world where every survivor of exploitation has access to transformative care. The Welcome Home Campaign is critical in providing opportunities for survivors to break barriers and chart a new path forward."

**Ed Bastian, CEO, Delta Air Lines**

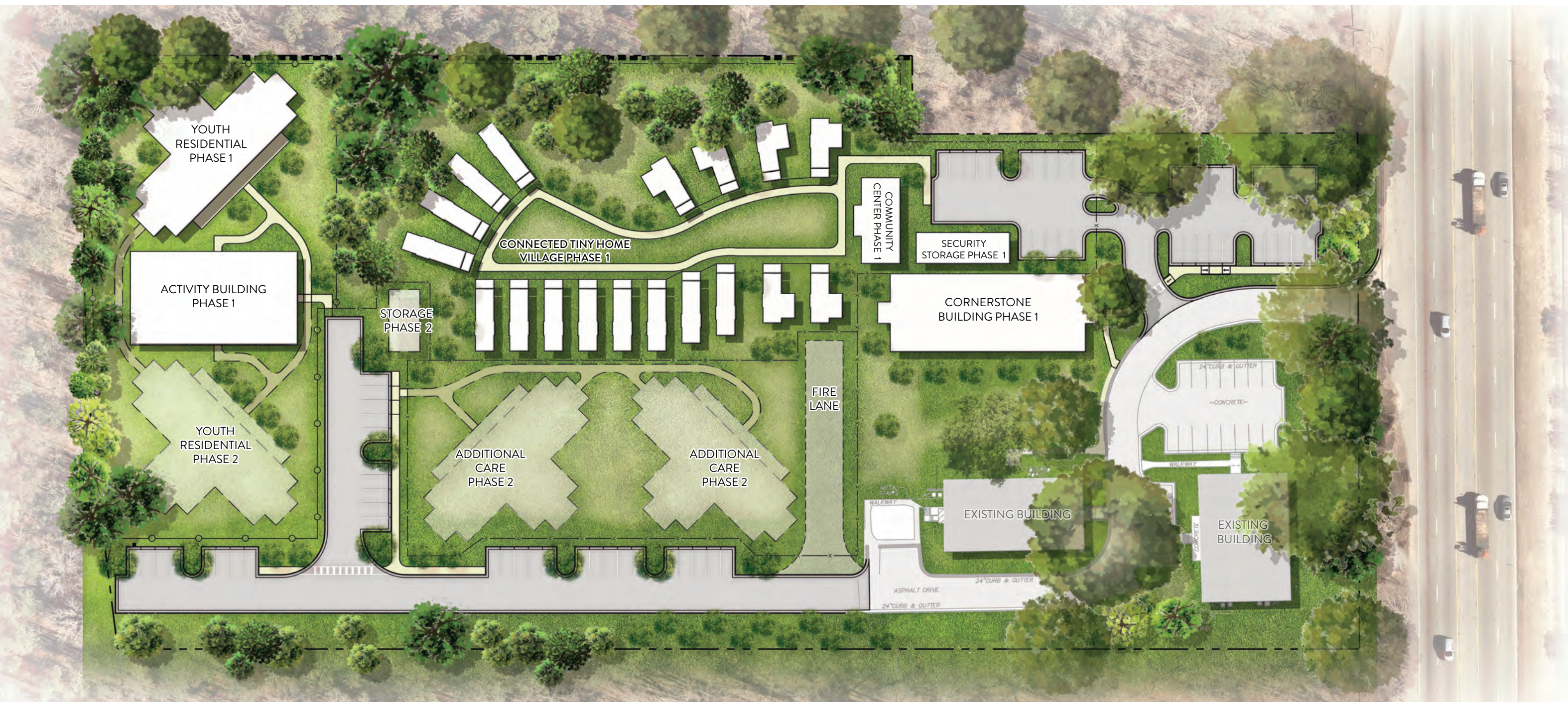

# Deepening OUR IMPACT

## CORNERSTONE BUILDING

This training and supportive services facility will provide the **Women's Academy** with a permanent home, increasing annual capacity by 25% to 200+ participants. This signature offering provides access to resources that empower women to avoid re-exploitation and reach their fullest potential, including therapy, life skills classes, GED and career certifications, and apprenticeship opportunities. The space will also be home to Institute programming and administrative offices, along with our food pantry and clothing boutique.

## YOUTH RESIDENTIAL PROGRAM BUILDING

This building will provide long-term residential services for up to 32 trafficked youth of all genders ages 12 -17, increasing the number of youth Wellspring Living serves annually on our South Campus by nearly 25% and creating **Georgia's first residential program for trafficked boys**. Each residence will feature a private bedroom and bathroom, giving each participant a safe space for healing.

## ACTIVITIES & TRAINING BUILDING

The space will offer dedicated classrooms for our **fully accredited school**, which provides individual learning plans so youth can remain on track to earning their high school diploma—a roadblock many trafficked youth face, making it difficult to break the generational cycle of poverty. When school is not in session, these classrooms will be used by Institute clients for training while larger multi-use spaces will accommodate sports and wellness programming for youth, women, and their children.

## GRADUATE VILLAGE SOUTH

Featuring 18 tiny homes, two community buildings, and a common greenspace, our Graduate Village South will provide program graduates and their children up to three years of continued support with reduced rent, offering a **step-down transition** to enable greater life stabilization and minimize risk of re-exploitation. Graduates are encouraged to build their savings during this time to use as a nest egg for life's next step.

"I can still say that my **10 months in this program allowed for some of the best moments of my life**. It's beautiful and it's hard. There were people here who loved me when I couldn't love myself. That's my goal: to offer hope and joy and show people love until they are able to love themselves."

**Andrea Hipwell**, Director of Women's Residential Services, Wellspring Living & Appointed Member, United States Advisory Council on Human Trafficking



# Welcome Home Campaign SUMMARY

**DEEPENING OUR IMPACT** **\$16,000,000**

These projects will enable Wellspring Living to offer a comprehensive continuum of care on our South Campus, allowing us to deepen our impact, enhance operational efficiencies, and accommodate a greater number of survivors at every step along their path to freedom and self-sufficiency.

**Cornerstone Building** **\$5,200,000**  
*A 19,700 sq. ft training and supportive services center that will serve 200+ women participating in the Women's Academy along with 100+ Wellspring Living Institute clients annually.*

**Youth Residential Program Building** **\$4,600,000**  
*A 13,000 sq. ft building home to 15 youth residences that will serve 32+ youth of all genders each year.*

**Activities & Training Building** **\$3,700,000**  
*An 8,650 sq. ft facility home to classrooms that support our accredited school program and Institute training, along with sports and wellness programming.*

**Graduate Village South** **\$2,500,000**  
*Features eighteen 450 sq. ft tiny homes, two community buildings, and a park for families to thrive together and achieve sustainable restoration, thereby minimizing risk of re-exploitation.*

**BROADENING AND SUSTAINING OUR IMPACT** **\$4,000,000**

These campaign components will build Wellspring Living's capacity to serve a greater number of survivors today and in the future.

**Capacity Building & Program Expansion** **\$4,000,000**  
*Campaign funds will support the increased operating costs that come with expanding our programming and services over a three-year period to serve a greater number of survivors.*

**CAMPAIGN TOTAL** **\$20 MILLION**

“Every day in Metro Atlanta—in our own neighborhoods and communities—**hundreds of youth and women are weathering storms few of us can imagine.** Wellspring Living is there like a light on the front porch during the storm, offering safety, freedom, restoration, and hope to those at risk for or survivors of trafficking. Together, we can help Wellspring Living shine that light even brighter and say ‘Welcome Home’ to more individuals ready to start their healing journey. We invite you to stand shoulder to shoulder with Wellspring Living and the courageous survivors it serves.”

**LaShonda Foy and Lamar Wakefield, Campaign Co-Chairs**





*Welcome Home*

The Capital Campaign for  Wellspring Living

**For more information, please contact:**

**Mary Frances Bowley**

*Executive Director*

404-427-2798

[mbowley@wellspringliving.org](mailto:mbowley@wellspringliving.org)

**Christian Murphy**

*Deputy Director*

404-707-4916

[cmurphy@wellspringliving.org](mailto:cmurphy@wellspringliving.org)

**Wellspring Living**

1040 Boulevard SE, Suite M

Atlanta, GA 30312

[wellspringliving.org/welcomehome](http://wellspringliving.org/welcomehome)

